

SCALE 1/1

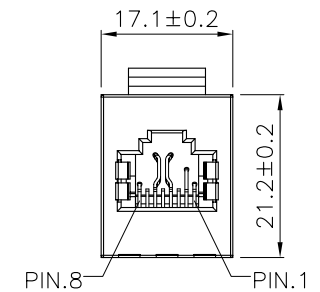
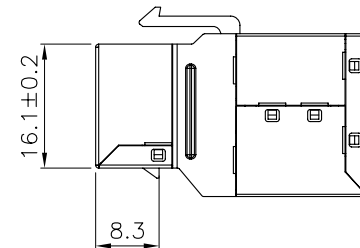
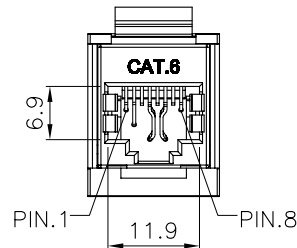

Specification :

Material :

1. RJ45 Jack Housing : ABS+PC, UL 94V-0, Black color.
2. RJ45 Jack Bracket Set : PC, UL 94V-2, Transparent color.
3. RJ45 Jack Shield : Bronze, Nickel plated.
4. RJ45 Jack Contact :
 - 4-1. Material : Phosphor Bronze with Nickel plated.
 - 4-2. Finish : 50 micro-inch Gold plated on Plug contact area.
5. PCB : FR4, UL 94V-0.

Performance :

- a. Insertion force : 30N max. (IEC 60603-7-5).
- b. Retention strength : 7.7 kg between Jack and Plug.
- c. Operating temperature : -10°C to 60°C. (ISO/IEC 11801, ANSI/TIA/EIA 568 B.2)
- d. Life(mating cycles) : 750 cycles min. (ISO/IEC 11801, IEC 60603-7-5).
- e. The Cat.6 transmission performance is in compliance with the ANSI/TIA/EIA 568 B.2-1 standard.

| | | | | | |
|--------------------------------------|---|-------------|-------|-------------------------|---|
| GENERAL TOLERANCE OF DIMENSIONS ±0.1 | DRAWING | 21.MAY.2010 | QIQI | | |
| | CHECK | 21.MAY.2010 | JANE | | |
| | APPROVAL | 21.MAY.2010 | JAIMY | | |
| | | DATE | NAME | ITEM NO.: CL-210B-C6-SH | |
| | SCALE | 1/1 (A4) | UNIT | mm | DES.: CAT.6 FULL SHIELDED KEYSTONE JACK |
| | DRAWING NO. AAEAB0001141215 KJ9AS-C6(SA2) | | | | |
| | DRAWING CLASSIFICATION | | S | SHEET 1 OF 1 | |